

# INTENSIVE ENGLISH LANGUAGE PROGRAM





## STUDY ENGLISH IN SEATTLE – ONE OF THE FASTEST GROWING CITIES IN THE U.S.

Located on City University of Seattle's main campus in downtown Seattle, Washington Academy of Languages is an exciting place to study in one of the most international cities in the United States.

Seattle offers many opportunities to practice English outside the classroom through volunteer work and also through our conversation partner program, where students can meet with native English speakers for a language exchange.

## WHAT CAN I DO IN SEATTLE?

Seattle is a great place to live, learn, and explore. Here are some reasons why Seattle is a great choice for you:

- **Safe** – Seattle has been ranked as one of the safest large cities in the United States.
- **Clean** – Seattle has been ranked the second cleanest city in the United States.
- **Exciting** – Seattle has professional sports teams with passionate fans, a lively food and restaurant scene, and exciting festivals and events year round.
- **Convenient** – Seattle has an excellent transportation system, making it easy to travel around the city by bus, light rail, and streetcar. Sea-Tac airport is also connected to the city via train and has many international flight options.
- **International** – Seattle is one of the most important cities on the West Coast of the United States. Many global corporations have headquarters in Seattle, including Microsoft, Amazon, Starbucks, and Boeing.

## WHAT IS THE PROGRAM LIKE?



- Our classes focus on learning all four English language skills – reading, writing, speaking, and listening, and you will learn all of the skills together for greater efficiency and fluency.
- Classes are 20 hours per week. You will have two hours of listening/speaking class and two hours of reading/writing class each weekday.
- The English Language Program consists of nine levels, so you can begin regardless of your current English skills.
- You will see your language abilities improve, which will help you move toward your goals.
- Some of our students go on to study in colleges and universities, some use English at work, and others are able to greatly improve their test scores.





## ENGLISH PLACEMENT

After the English Language Program you may begin degree programs at CityU after finishing certain levels:

Completed Level	CityU Program	Approximate TOEFL score equivalent
Level 6 (Certificate Awarded)	CityU Bachelor's degrees CityU Language-Assisted Master's Degrees	76-89 iBT 76-89 iBT
Level 8 (Certificate Awarded)	CityU Master's degrees	90+ iBT

## WHERE CAN I LIVE IN SEATTLE?

### Residence Hall

CityU's modern and convenient residence hall is located very close to the campus, with many facilities and student activities available for a very reasonable price. The residence hall includes activities for residents, so it is a great place to make new friends!

### Homestays

If you are staying for a shorter period of time or want to experience a bit more of everyday life in the U.S., consider a homestay. We can refer you to local homestay agencies.

### Apartments

You can choose to stay in an apartment of your choosing, and Seattle's efficient bus and train system makes it very easy to get downtown to class.

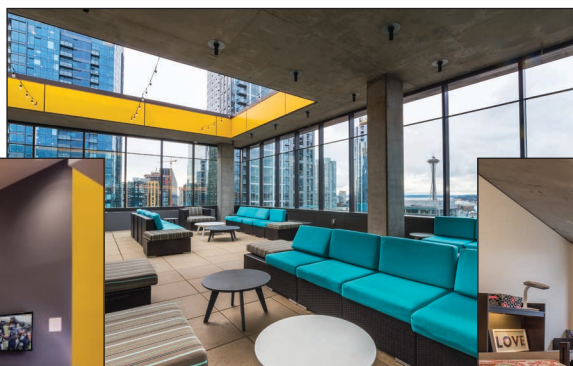

CityU Residence Hall



<b>Class Options</b>	One Session (5 weeks)	<b>Class Size (avg.)</b>	12 students
<b>Levels</b>	One Level (10 weeks)	<b>Minimum Age</b>	16 years
<b>School Location</b>	Downtown Seattle	<b>Classroom hours</b>	20 per week
<b>Housing options</b>	CityU residence hall, apartments, homestay		
<b>Start Dates</b>	January, February, April, May, July, August, October, November (8 times per year)		
<b>Tuition and Fees</b>	One Session (5 weeks): \$1,784 One Level (10 weeks): \$3,568		
<b>Living Expenses*</b>	\$4,300 per Quarter (10 weeks)		
<b>Total Cost Per Quarter*</b>	\$3,568 + \$4,300 = <b>\$7,868</b>		
<b>Total Cost Per Year*</b>	<b>\$28,272</b> (includes vacation quarter)		

\*This rate is effective for the 2017/18 academic year (July 1, 2017 – June 30, 2018). This rate is subject to change for the 2018/19 academic year.

## IT'S EASY TO APPLY

Submit the following items that you can find at <http://www.wal.org>:

1. Application Form
2. Copy of your Passport ID page or US Permanent Resident Card
3. For F-1 students: a copy of your or your sponsor's bank statement documenting the necessary amount
4. Transfer students must submit additional documents, please email us at [WAL@CityU.edu](mailto:WAL@CityU.edu)
5. \$50 application fee



### CONTACT INFORMATION:

[www.wal.org](http://www.wal.org)  
[www.facebook.com/washingtonacademyoflanguages](https://www.facebook.com/washingtonacademyoflanguages)  
[wal@CityU.edu](mailto:wal@CityU.edu) | 206.239.4780